

PREPARED BY THE NORTH DAKOTA STATE WATER COMMISSION

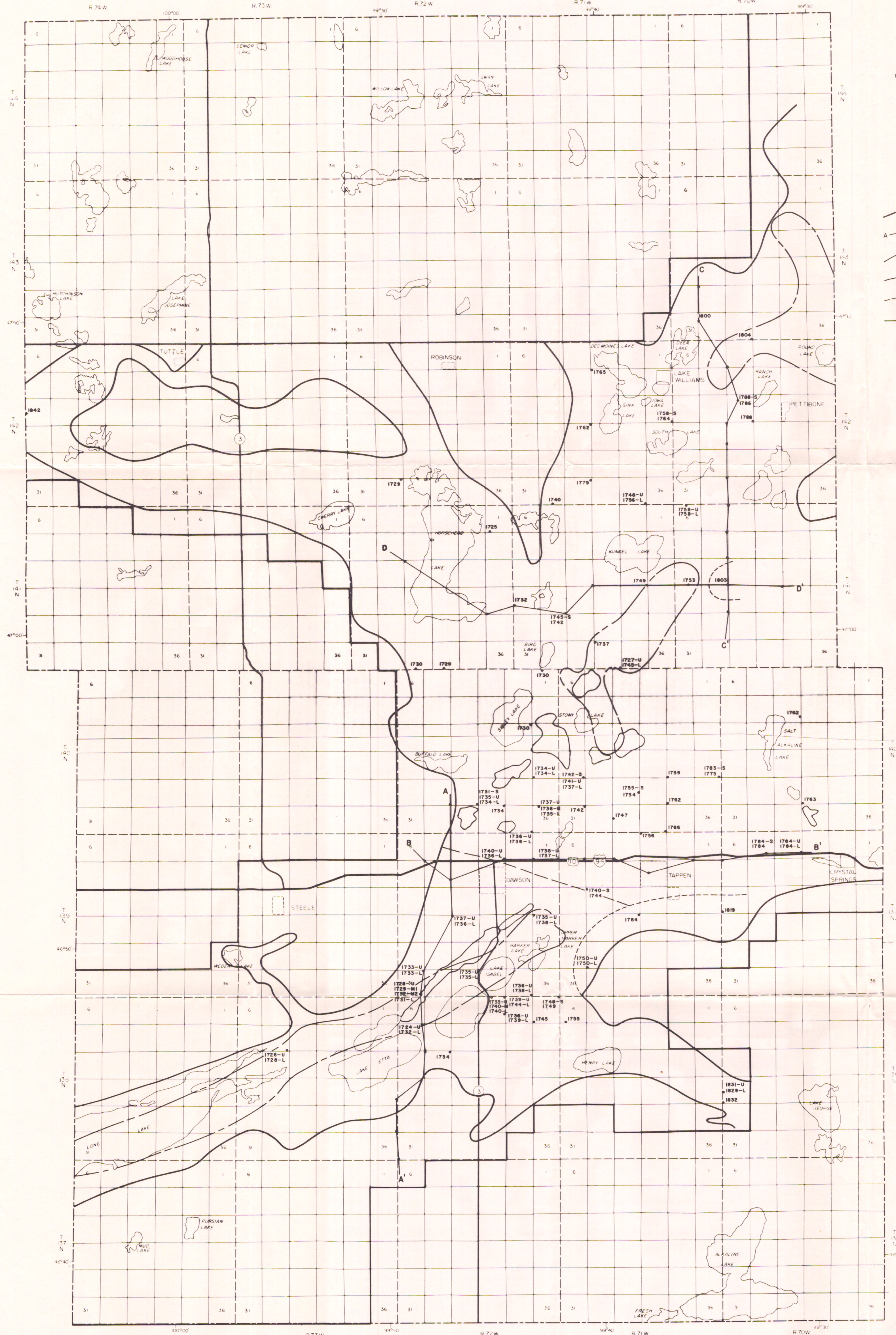

- EXPLANATION**
- 1528 • Control Point—Number is water-level elevation in feet above National Geodetic Vertical Datum of 1929 and measured June 22-23, 1982
 - S—water-level elevation in observation well completed in the surficial at multi-well sites
 - U—water-level elevation in upper observation well
 - M—water-level elevation in middle observation well
 - L—water-level elevation in lower observation well
 - Aquifer Boundary based on line of 50 gpm potential yield
 - A—A' Line of Cross-Section on Plate 10
 - - - Outline of Deep Unit—Kidder County Aquifer Complex
 - - - Apparent Ground-Water Divide
 - - - Apparent Low-Flow Boundary
 - Outline of Study Area

BASE PREPARED FROM NORTH DAKOTA STATE HIGHWAY DEPARTMENT COUNTY HIGHWAY MAP HYDROGEOLOGY BY D.R. LARSON, 1985

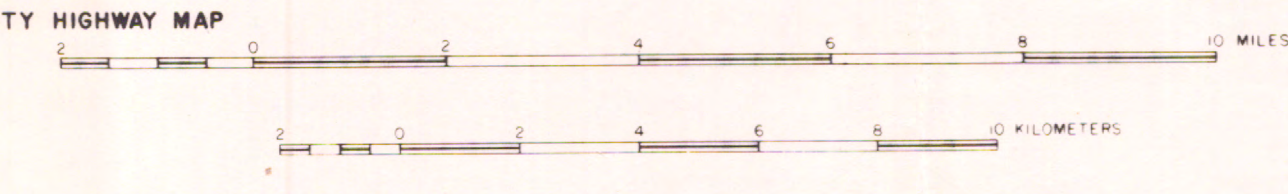

PLATE 6. MAP SHOWING KIDDER COUNTY AQUIFER COMPLEX, LINES OF CROSS-SECTIONS, AND WATER-LEVEL ELEVATIONS—KIDDER COUNTY