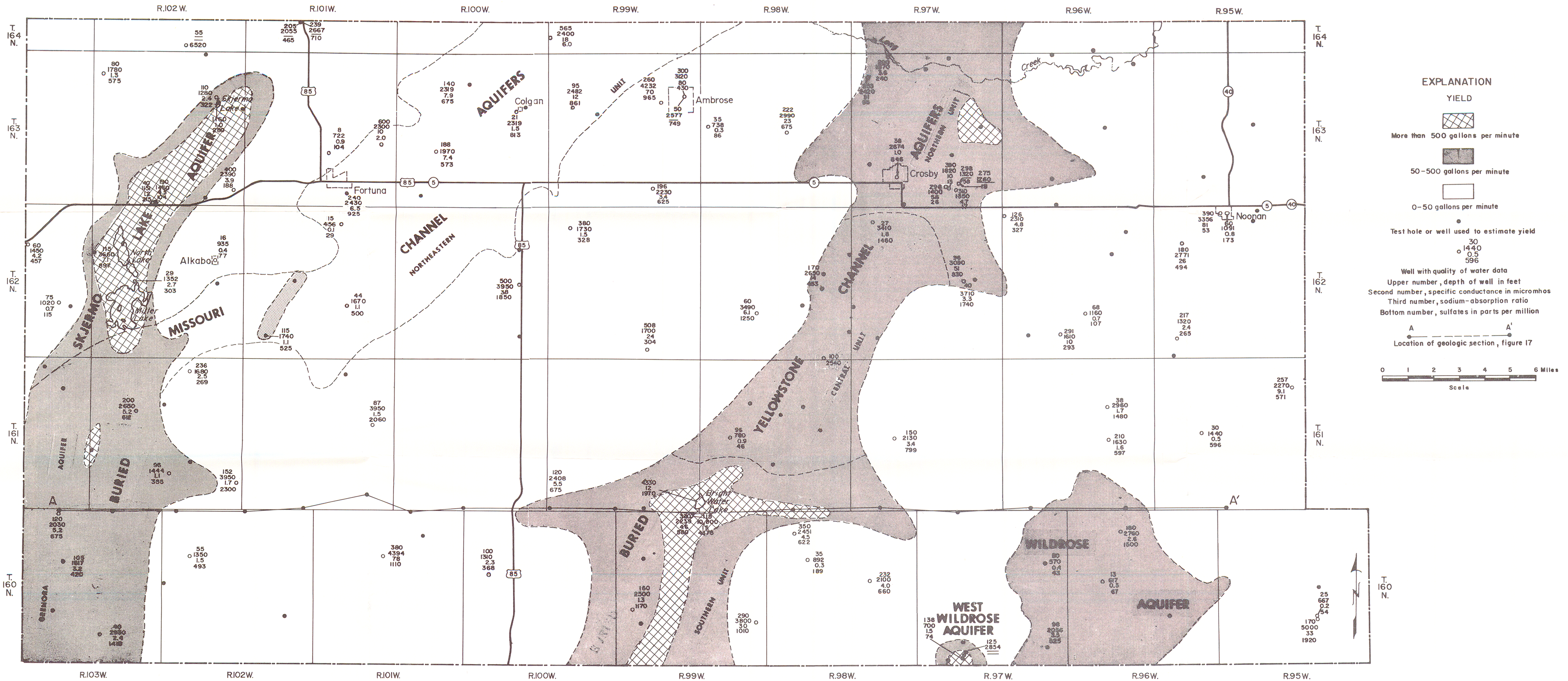
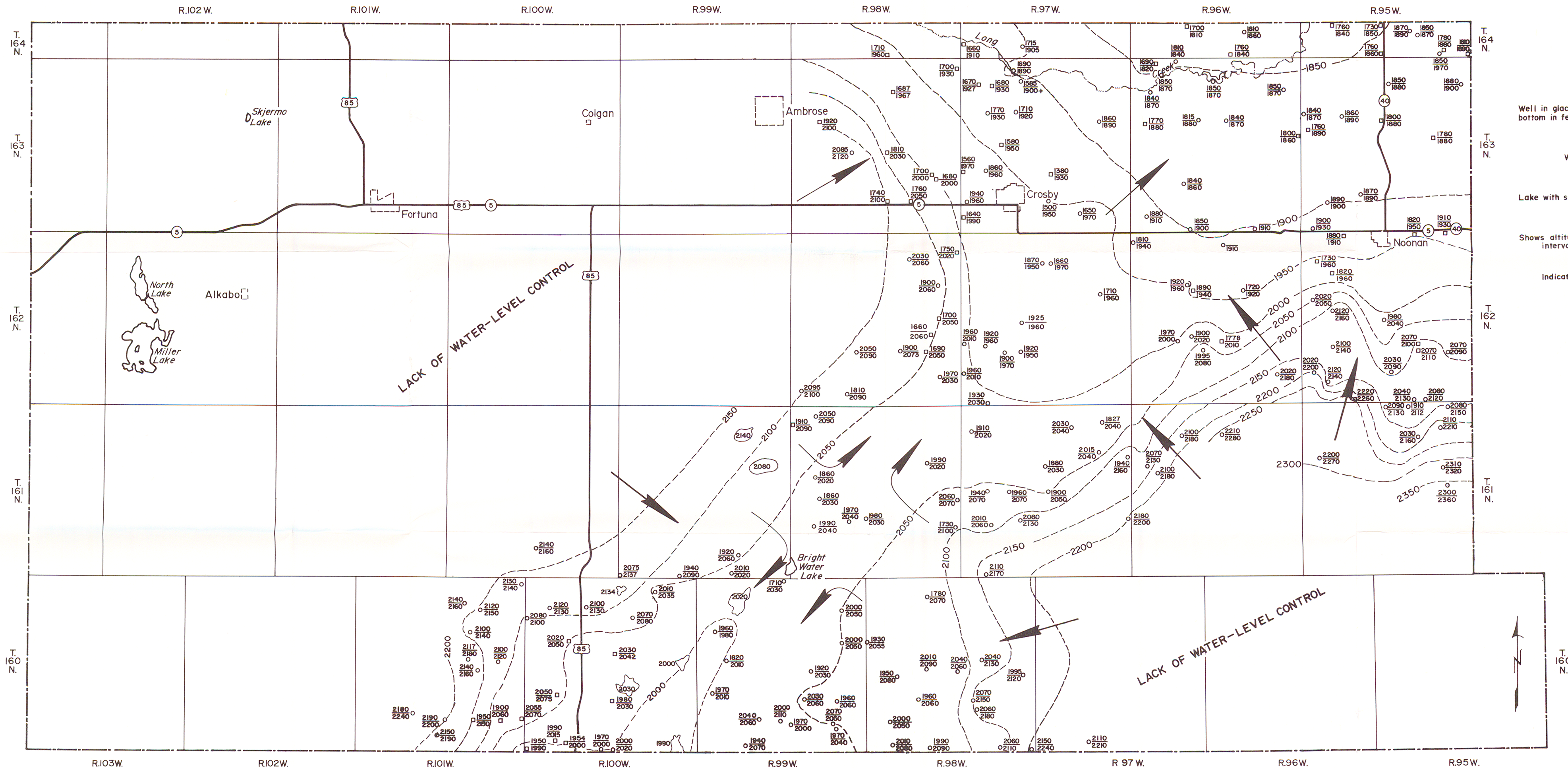

Figure 5. Map showing bedrock topography in Divide County, North Dakota.



Base prepared from North Dakota Highway Department county highway maps.

Figure 9. Map showing availability of ground water in Divide County, North Dakota.



EXPLANATION

- 1860
○ 1990
Well in glacial drift; upper number is altitude of well bottom in feet above mean sea level, lower number is altitude of water level
- Well in Tonque River Formation
- 2000
Lake with surface altitude, in feet above mean sea level
- 2000---
Piezometric contour
Shows altitude to which water will rise in wells, contour interval 50 feet, datum is mean sea level
- Indicates direction of ground-water movement

0 1 2 3 4 Miles
SCALE

Base prepared from North Dakota Highway Department county highway maps.

Figure 6. Map showing configuration of the piezometric surface (1960-64) in Divide County, North Dakota.