



- EXPLANATION**
- Test hole, log in table 3
 - Domestic or stock well
 - ⊙ Public supply, industrial, or irrigation well
 - ⊛ Commercial test hole
 - ⊔ Spring
 - ▽ Surface-water sampling point, analysis in table 5
- Modifications used with above symbols**
- Specific conductance in table 1
 - Water-level measurements in table 2
 - Log in table 3
 - Chemical analysis in table 4
 - ² More than one well at this location

BASE PREPARED FROM NORTH DAKOTA STATE HIGHWAY DEPARTMENT COUNTY HIGHWAY MAPS

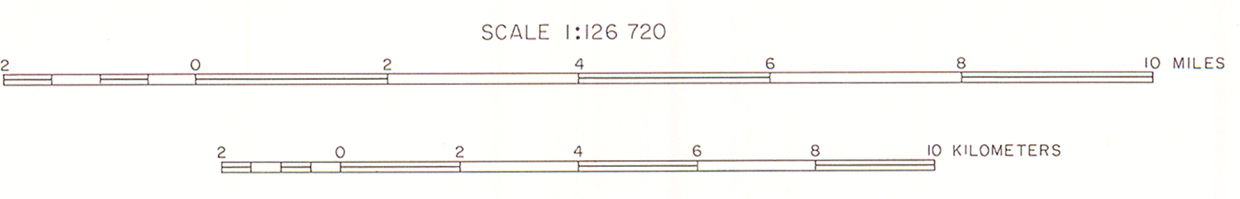
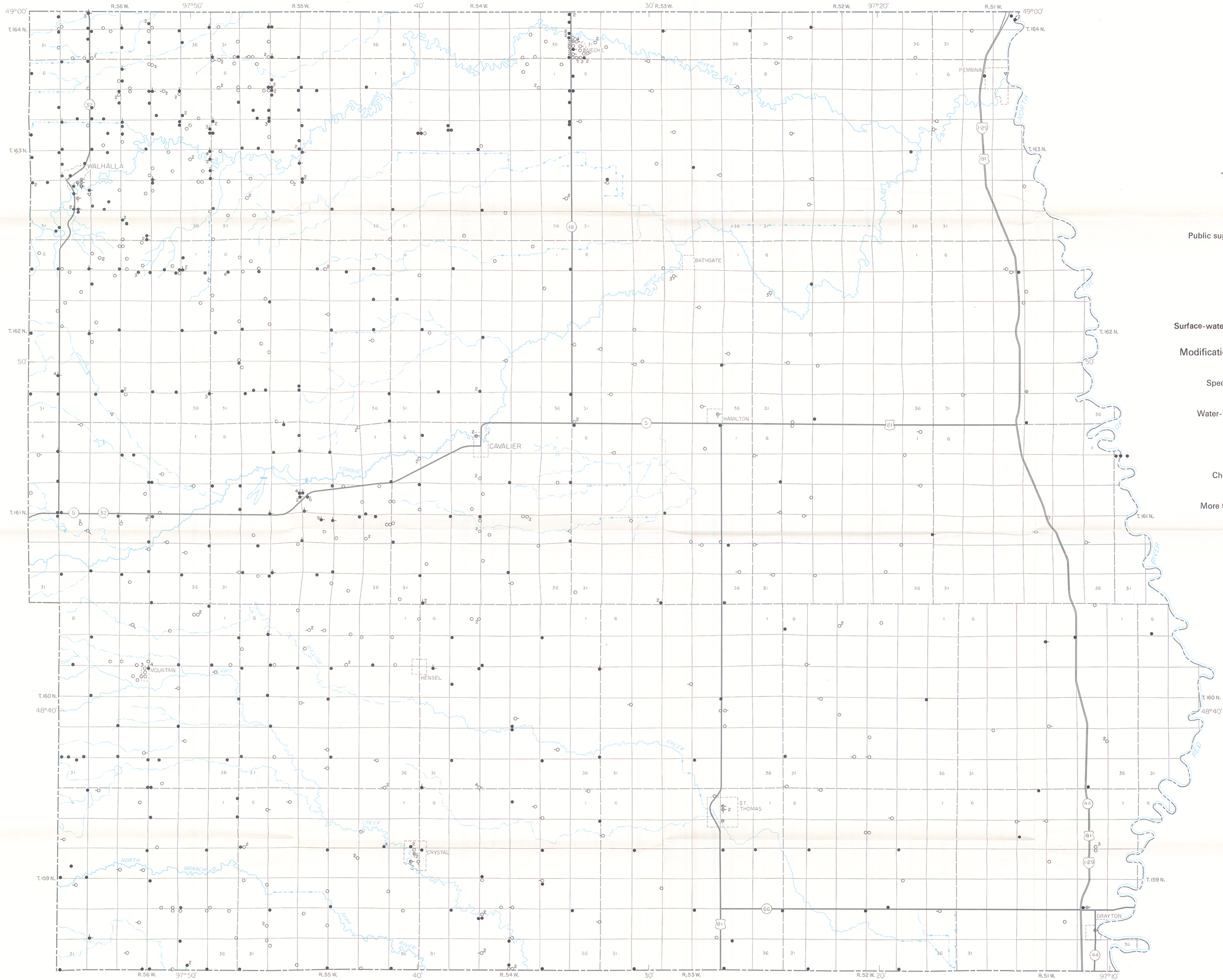

PLATE 1.—MAP SHOWING LOCATIONS OF WELLS, TEST HOLES, AND SPRINGS IN CAVALIER COUNTY, NORTH DAKOTA



EXPLANATION

- Test hole, log in table 3
- Domestic or stock well
- ⊙ Public supply, industrial, or irrigation well
- ⊛ Commercial test hole
- ⊕ Spring
- ▽ Surface-water sampling point, analysis in table 5
- Modifications used with above symbols
- Specific conductance in table 1
- Water-level measurements in table 2
- Log in table 3
- Chemical analysis in table 4
- ² More than one well at this location

BASE PREPARED FROM NORTH DAKOTA STATE HIGHWAY DEPARTMENT COUNTY HIGHWAY MAPS

SCALE 1:126 720

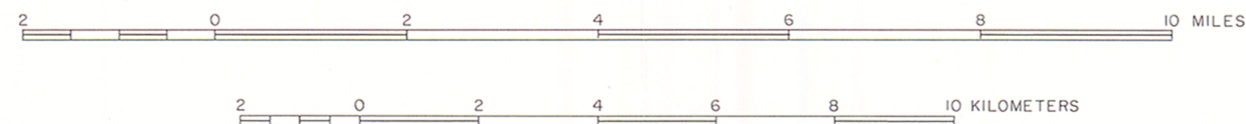

PLATE 2.—MAP SHOWING LOCATIONS OF WELLS, TEST HOLES, AND SPRINGS IN PEMBINA COUNTY, NORTH DAKOTA